

"N" SOCK HEAD BOLTS  
 SIZE "S"  
 TIGHTENING TORQUE - MA

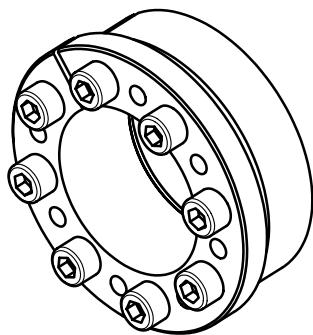

	L1	L2	L3	L4	N	S	Ma	MASS	Transmissible torque	Transmissible axial force	Hub contact pressure	Shaft contact pressure
	mm	mm	mm	mm			Nm	kg	Nm	kN	MPa	MPa
20x47	17	22	28	34	5	M6x20	17	0.27	280	28	93	219
22x47	17	22	28	34	5	M6x20	17	0.28	310	28	94	200
24x50	17	22	28	34	5	M6x20	17	0.30	340	28	89	185
25x50	17	22	28	34	6	M6x20	17	0.30	420	34	105	210
28x55	17	22	28	34	6	M6x20	17	0.35	470	33	96	187
30x55	17	22	28	34	6	M6x20	17	0.35	500	33	95	174
32x60	17	22	28	34	8	M6x20	17	0.40	720	45	118	220
35x60	17	22	28	34	8	M6x20	17	0.39	780	45	116	199
38x65	17	22	28	34	8	M6x20	17	0.43	850	45	108	184
40x65	17	22	28	34	8	M6x20	17	0.45	900	45	108	176
45x75	20	25	33	41	8	M8x25	41	0.70	1750	77	128	214
50x80	20	25	34	42	8	M8x25	41	0.80	1950	78	120	213
55x85	20	25	34	42	8	M8x25	41	0.85	2250	100	130	222
60x90	20	25	34	42	8	M8x25	41	0.90	2475	83	122	203
65x95	20	25	34	42	9	M8x25	41	0.96	3025	93	131	205
70x100	24	30	42	52	8	M10x30	83	1.70	4600	131	132	227
75x115	24	30	42	52	8	M10x30	83	1.82	4925	131	126	212
80x120	24	30	42	52	8	M10x30	83	1.92	5250	131	121	198
85x125	24	30	42	52	9	M10x30	83	1.90	6300	148	131	210
90x130	24	30	42	52	9	M10x30	83	2.10	6650	148	126	198
95x135	24	30	42	52	10	M10x30	83	2.20	7800	164	135	209
100x145	26	32	46	58	9	M12x35	145	2.90	10750	215	152	229
110x155	26	32	46	58	9	M12x35	145	3.20	11850	215	142	208
120x165	26	32	46	58	9	M12x35	145	3.40	12900	215	133	191
130x180	34	40	57	71	9	M14x40	230	5.10	19200	295	128	195
140x190	34	40	57	71	9	M14x40	230	5.40	20700	295	121	181
150x200	34	40	57	71	10	M14x40	230	5.70	24600	328	128	187
160x210	34	40	57	71	12	M14x40	230	6.00	28900	361	134	193
170x225	44	50	67	81	12	M14x40	230	8.30	33500	394	108	150
180x235	44	50	67	81	12	M14x40	230	8.80	35500	394	101	142
190x250	44	50	67	83	12	M16x50	355	10.2	52000	597	132	187
200x260	44	50	67	83	12	M16x50	355	10.7	54800	548	127	177
220x285	50	56	75	91	12	M16x50	355	14.4	60200	548	102	141
240x305	50	56	75	91	15	M16x50	355	15.5	82200	685	119	161
260x325	50	56	75	91	18	M16x50	355	16.7	114000	877	145	180
280x355	60	66	87	105	18	M18x60	485	24.0	123050	879	110	139
300x375	60	66	87	105	18	M18x60	485	25.5	148300	989	117	146
320x405	74	81	104	124	18	M20x60	690	38.0	182500	1141	101	128
340x425	74	81	104	124	21	M20x60	690	40.0	218000	1282	109	136
360x455	86	94	120	142	18	M22x60	930	48.0	290000	1611	109	138
380x475	86	94	120	142	21	M22x60	930	57.0	305000	1605	105	131
400x495	86	94	120	142	21	M22x60	930	63.0	355000	1775	111	137